

# Mikalor ASFA S (WD-DIN-12)

DIN 3017 Worm Drive Hose Clamps 12mm wide

**MIKALOR**



## Description

Mikalor's patented ASFA-S premium Worm Drive hose clamps are manufactured Spain in accordance with DIN3017 and is available in W2 and W4 Stainless Steel.

The innovative housing is designed for high strength whilst remaining compact. The cold-formed stamped band is smooth on the underside and bevelled at the edges, protecting the hose from damage. Mikalor's Worm Drive Hose Clips are manufactured to the highest quality from Stainless Steel material.

# Mikalor ASFA S (WD-DIN-12)

DIN 3017 Worm Drive Hose Clamps 12mm wide



Part Number* HCL	Minimum Diameter (A)		Max Diameter (A)		Band Width (B)		Band Thickness (C)		Screw (D) mm A/F	Max Torque Nm	Max Pressure Bars	Mikalor Part Number	
	mm	inch	mm	inch	mm	inch	mm	inch				W2	W4
WD-12-DIN-16	16	0.630	27	1.063	12.2	0.480	0.8	0.031	7.0	4.2	45	03014730	03014019
WD-12-DIN-20	20	0.787	32	1.260						5.2	45	03014510	03014027
WD-12-DIN-25	25	0.984	40	1.575							40	03014529	03014035
WD-12-DIN-30	30	1.181	45	1.772						35	03014748	03014043	
WD-12-DIN-32	32	1.260	50	1.969						6	35	03014537	03014051
WD-12-DIN-40	40	1.575	60	2.362							30	03014545	03014060
WD-12-DIN-50	50	1.969	70	2.756						6.8	25	03014553	03014078
WD-12-DIN-60	60	2.362	80	3.150							20	03014561	03014086
WD-12-DIN-70	70	2.756	90	3.543							17	03014570	03014094
WD-12-DIN-80	80	3.150	100	3.937							14	03014588	03014107
WD-12-DIN-90	90	3.543	110	4.331							12	03014596	03014115
WD-12-DIN-100	100	3.937	120	4.724							10	03014609	03014123
WD-12-DIN-110	110	4.331	130	5.118							8	03014617	03014140
WD-12-DIN-120	120	4.724	140	5.512							7	03014625	03014158
WD-12-DIN-130	130	5.118	150	5.906							6	03014633	03014166
WD-12-DIN-140	140	5.512	160	6.299							5	03014641	03014174
WD-12-DIN-150	150	5.906	170	6.693						4	03014650	03014182	
WD-12-DIN-160	160	6.299	180	7.087						3	03014668	03014668	
WD-12-DIN-170	170	6.693	190	7.480						2	03014678	03014678	
WD-12-DIN-180	180	7.087	200	7.874						2	03014684	03014684	
WD-12-DIN-190	190	7.480	210	8.268						1.8	03014692	03014692	
WD-12-DIN-200	200	7.874	220	8.661						1.8	03014705	03014705	
WD-12-DIN-210	210	8.268	230	9.055	1.6	03014713	03014713						
WD-12-DIN-220	220	8.661	240	9.449	1.6	03014721	03014190						

\* To identify different materials add either -W2 or -W4 to the end of the HCL part numbers

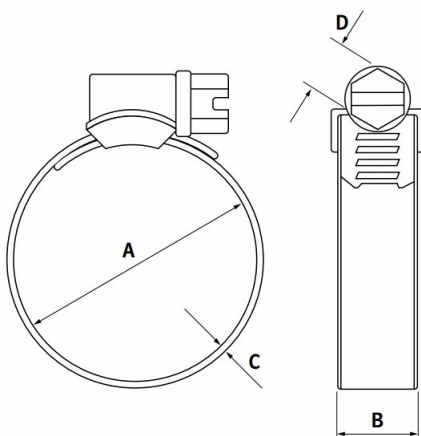

## Product Information

Made by:	Mikalor Spain
Manufactured according to:	DIN 3017
RoHS Compliant:	Yes
Hazardous Goods:	No
Maximum tightening speed RPM:	540 ±5

## Material Information

	W2	W4
Band & Housing:	430 Stainless Steel	304 Stainless Steel
Screw:	Mild Zinc Plated Steel	

