

# Mikalor ASFA (WD-DIN-9)

DIN 3017 Worm Drive Hose Clamps 9mm wide



## Description

Thanks to the exclusive design of the housing and the high-strength screw, the ASFA L W2 and W4 Worm-Drive Clips have excellent performance while being at the same time very compact.

The cold-formed stamped 9mm band, smoothed on the underside, combined with the bevelled band edges protects the hose from any damage.

These hose clips comply fully with the DIN 3017 norm and also with the directive EU 2002/95/EC. This clip is ideal for general industrial applications.

\* The maximum application pressure can vary depending on the type of hose used and the geometry of the coupling.

# Mikalor ASFA L (WD-DIN-9)

DIN 3017 Worm Drive Hose Clamps 9mm wide



Part Number* HCL	Minimum Diameter (A)		Max Diameter (A)		Band Width (B)		Band Thickness (C)		Screw (D) mm A/F	Max Torque Nm	Max Pressure Bars	Mikalor Part Number			
	mm	inch	mm	inch	mm	inch	mm	inch				W2	W4		
WD-9-DIN-8	8.0	0.315	16.0	0.630	9.0	0.354	0.6	0.024	7.0	3.0	45	3016516	3014019		
WD-9-DIN-12	12.0	0.472	22.0	0.866								3016524	3014027		
WD-9-DIN-16	16.0	0.630	27.0	1.063								3.5	42	3016532	3014035
WD-9-DIN-20	20.0	0.787	32.0	1.260										3016540	3014043
WD-9-DIN-25	25.0	0.984	40.0	1.575			4.0	32	3016596	3014051					
WD-9-DIN-30	30.0	1.181	45.0	1.772					28	3016567	3014060				
WD-9-DIN-32	32.0	1.260	50.0	1.969					24	3016575	3014078				
WD-9-DIN-40	40.0	1.575	60.0	2.362					19	3016583	3014086				
WD-9-DIN-50	50.0	1.969	70.0	2.756					17	3016591	3014094				
WD-9-DIN-60	60.0	2.362	80.0	3.150					15	3016604	3014107				
WD-9-DIN-70	70.0	2.756	90.0	3.543					13	3016612	3014115				
WD-9-DIN-80	80.0	3.150	100.0	3.937					11	3016620	3014123				
WD-9-DIN-90	90.0	3.543	110.0	4.331					10	3016639	3014140				
WD-9-DIN-100	100.0	3.937	120.0	4.724					9	3016647	3014158				
WD-9-DIN-110	110.0	4.331	130.0	5.118	8	3016655	3014166								
WD-9-DIN-120	120.0	4.724	140.0	5.512	7	3016663	3014174								
WD-9-DIN-130	130.0	5.118	150.0	5.906	6	3016671	3014182								
WD-9-DIN-140	140.0	5.512	160.0	6.299	5	3016680	3014190								

\* To identify different materials add either -W2 or -W4 to the end of the HCL part numbers

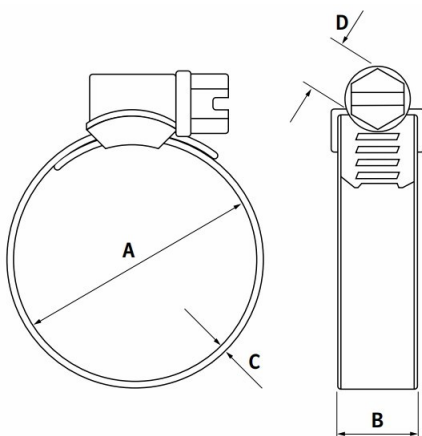

## Product Information

Made by:	Mikalor Spain
Manufactured according to:	DIN 3017
RoHS Compliant:	Yes
Hazardous Goods:	No
Maximum tightening speed RPM:	540 ±5

## Material Information

	W2	W4
Band & Housing:	430 Stainless Steel	304 Stainless Steel
Screw:	Mild Zinc Plated Steel	

