

# EARTHING MADE EASY!

## EZYBOND®

### PIPE EARTH CLAMPS

**For 15mm and 22mm pipes  
and conductors up to 10mm<sup>2</sup>**

Manufactured in heat and UV stabilised nylon 6.6. embodying excellent mechanical properties, chemical, heat resistance and self extinguishing characteristics. Patented double tooth jaw with conductor vane guides design and security locking.

British made - Patent No. 0122709.9  
Certificate of conformity available.

#### Significant advantages include:

- More than halves installation time
- Continuous uniform metal contact
- No screws or loose parts
- ASTA approved electrical tests to BS951:1999
- No sharp edges and no corrosion
- Increased security
- Cross-bonding becomes a simple operation with continuous uniform contact
- Always correct size for pipe fitted
- Manufactured to ISO 9001-2000

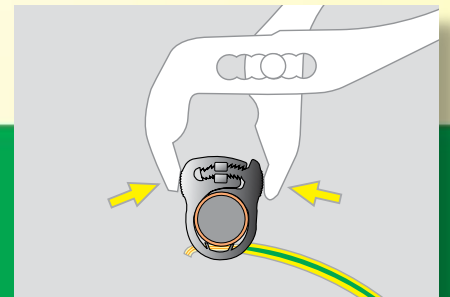
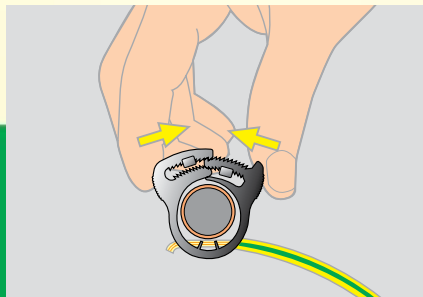
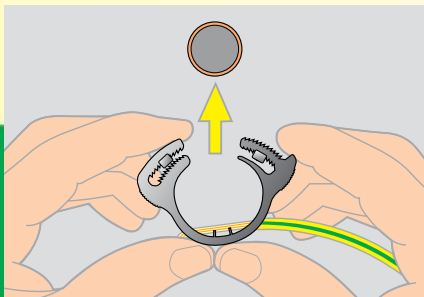
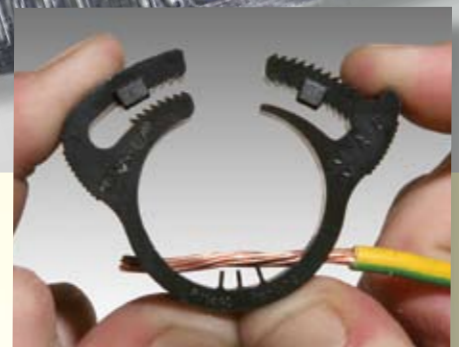

The two first teeth of the jaw have been designed to allow the clamp to be tightened initially by hand, and once clamp is positioned in desired location the fastening operation is completed by pliers. Locking tabs prevent release of the jaws once the clamp is secured.

## Simply the best on earth!

Available through leading electrical wholesalers